

2500 Series

Euro-Design



2500 Series

- Weighs less than most cylinders of similar design
- Chrome-plated LPA
- Optional self-aligning bearing
- Lifting capacity comparable to other brands
- Dual-lip wiper prevent contamination entry
- Fits a variety of dump body and trailer applications
- 2800–3500 psi operating pressure
- Self-bleeding design
- State-of-the-art u-cups

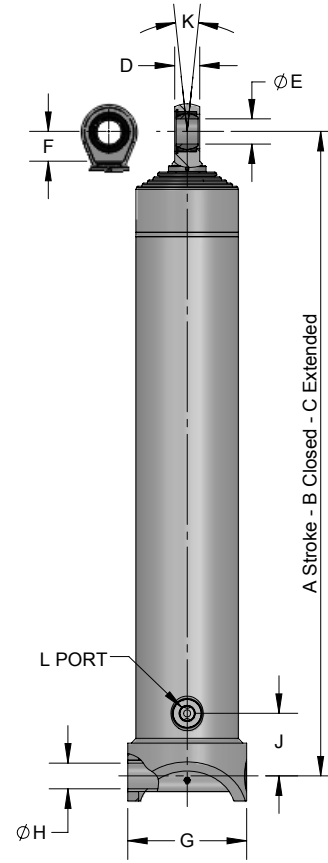

2500 Series

MODEL NUMBER	A		B		C		D		E		F		G		H		J		K	L	GAL of OIL		WEIGHT
	in	mm	in	mm	in	mm	in	mm	in	mm	in	mm	in	mm	in	mm	in	mm	TILT	PORT	FILL	EXT	lbs
1213-2502-2755	108.50	2756	50.50	1283	159.00	4039	1.63	41	2.00	51	2.19	56	6.69	170	2.06	52	13.00	330	12°	1" NPTF	0.9	6.0	204
1403-2504-3205	125.13	3178	56.50	1435	181.63	4613	1.63	41	2.00	51	2.19	56	8.63	219	2.06	52	14.75	375	12°	1" NPTF	1.2	9.8	287
1403-2509-3032	119.38	3032	53.00	1346	172.38	4378	2.00	51	2.06	52	1.75	44	7.63	194	2.06	52	19.50	495	N/A	1" NPTF	1.2	9.3	273
1403-2509-3185	125.38	3185	55.00	1397	180.38	4582	2.00	51	2.06	52	1.75	44	7.63	194	2.06	52	19.50	495	N/A	1" NPTF	1.2	9.8	282
1403-2509-3546	139.63	3546	59.75	1518	199.38	5064	2.00	51	2.06	52	1.75	44	7.63	194	2.06	52	19.50	495	N/A	1" NPTF	1.4	10.9	303
1404-2506-3680	142.25	3613	50.50	1283	192.75	4896	1.63	41	2.00	51	2.19	56	8.63	219	2.06	52	13.00	330	12°	1" NPTF	1.3	9.5	286
1624-2509-4280	166.25	4223	56.50	1435	222.75	5658	1.63	41	2.00	51	2.19	56	9.50	241	2.06	52	6.69	170	12°	1" NPTF	1.8	15.4	387
1624-2511-3680	142.25	3613	50.50	1283	192.75	4896	1.63	41	2.00	51	2.19	56	9.50	241	2.06	52	6.69	170	12°	1" NPTF	1.5	13.2	349
1624-2518-3416	134.50	3416	48.25	1226	182.75	4642	2.00	51	2.06	52	1.75	44	8.63	219	2.06	52	6.50	165	N/A	1" NPTF	1.4	12.5	346
1624-2518-3924	154.50	3924	53.38	1356	207.88	5280	2.00	51	2.06	52	1.75	44	8.63	219	2.06	52	6.50	165	N/A	1" NPTF	1.6	14.4	379
1624-2518-4216	166.00	4216	56.25	1429	222.25	5645	2.00	51	2.06	52	1.75	44	8.63	219	2.06	52	6.50	165	N/A	1" NPTF	1.8	15.4	397
1854-2508-3759	143.75	3651	51.50	1308	195.25	4959	2.00	51	2.00	51	2.38	60	9.50	241	2.06	52	5.00	127	N/A	1" NPTF	1.9	17.7	421
1854-2508-3962	151.75	3854	53.50	1359	205.25	5213	2.00	51	2.00	51	2.38	60	9.50	241	2.06	52	5.00	127	12°	1" NPTF	2.1	21.0	437
1854-2508-4089	157.25	3994	54.88	1394	212.13	5388	2.00	51	2.00	51	2.38	60	9.50	241	2.06	52	5.00	127	N/A	1" NPTF	1.9	17.7	445
1854-2508-4318	165.75	4210	57.00	1448	222.75	5658	2.00	51	2.00	51	2.38	60	9.50	241	2.06	52	5.00	127	12°	1" NPTF	2.1	21.0	463
1854-2508-4572	179.75	4566	60.50	1537	240.25	6102	2.00	51	2.00	51	2.38	60	9.50	241	2.06	52	5.00	127	12°	1" NPTF	2.2	22.3	481
1855-2509-5355	207.88	5280	56.75	1441	264.63	6721	1.63	41	2.00	51	2.19	56	10.25	260	2.06	52	6.69	170	12°	1" NPTF	2.4	22.8	502
1855-2510-4826	190.00	4826	53.88	1368	243.88	6194	2.00	51	2.00	51	2.38	60	9.50	241	2.06	52	10.00	254	12°	1" NPTF	2.2	21.0	474
1855-2510-5588	220.00	5588	59.88	1521	279.88	7109	2.00	51	2.00	51	2.38	60	9.50	241	2.06	52	10.00	254	12°	1" NPTF	2.5	24.2	522
1855-2510-5969	235.00	5969	65.00	1651	300.00	7620	2.00	51	2.00	51	2.38	60	9.50	241	2.06	52	10.00	254	12°	1" NPTF	2.7	25.8	562
1855-2510-6350	250.00	6350	68.00	1727	318.00	8077	2.00	51	2.00	51	2.38	60	9.50	241	2.06	52	10.00	254	12°	1" NPTF	2.8	27.5	586
1855-2510-6731	265.00	6731	70.88	1800	335.88	8531	2.00	51	2.00	51	2.38	60	9.50	241	2.06	52	10.00	254	12°	1" NPTF	3.0	29.1	613
1855-2510-7112	276.88	7033	72.25	1835	349.13	8868	2.00	51	2.00	51	2.38	60	9.50	241	2.06	52	10.00	254	12°	1" NPTF	3.1	30.4	644
2075-2505-7112	280.00	7112	72.25	1835	352.25	8947	2.00	51	2.00	51	2.38	60	10.63	270	2.06	52	6.57	167	12°	1" NPTF	3.7	40.5	754
2075-2505-7620	300.00	7620	76.25	1937	376.25	9557	2.00	51	2.00	51	2.38	60	10.63	270	2.06	52	6.57	167	12°	1" NPTF	4.0	43.4	816