

2600 Series

Euro-Design

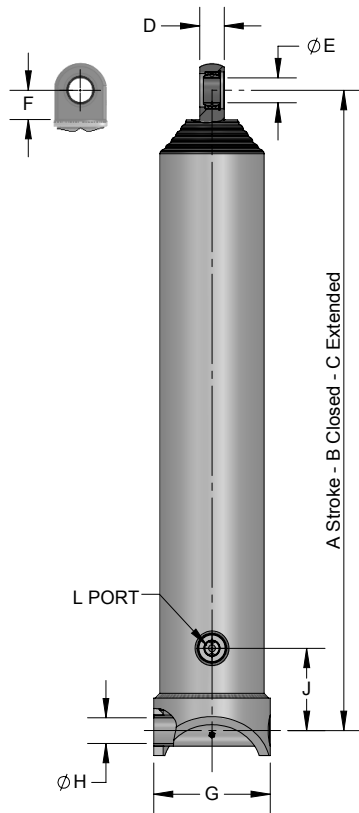

2600 Series

- Exact Euro cylinder design
- 110/130/150/170/190 mm (4.33"–7.48") stage diameters
- Strokes up to 400"
- Single-piece (no welds) plungers
- Cascading umbrella wipers
- Self-bleeding design
- System pressures to 3,500 psi
- Chrome-plated stages optional
- Optional spherical bearing



2600 Series

MODEL NUMBER	A		B		C		D		E		F		G		H		J		L	GAL of OIL			WEIGHT
	in	mm	in	mm	in	mm	in	mm	in	mm	in	mm	in	mm	in	mm	in	mm	PORT	FILL	EXT	lbs	
1503-2601-2755	107.00	2718	50.50	1283	157.50	4001	2.00	51	2.06	52	1.75	44	8.63	219	2.06	52	6.63	168	1" NPTF	0.8	9.5	237	
1503-2601-3226	126.50	3213	57.00	1448	183.50	4661	2.00	51	2.06	52	1.75	44	8.63	219	2.06	52	6.63	168	1" NPTF	0.9	11.3	268	
1904-2601-3760	147.75	3753	52.00	1321	199.75	5074	2.00	51	2.06	52	1.75	44	9.50	241	2.06	52	6.63	168	1" NPTF	1.5	20.1	490	
1904-2601-3980	156.75	3981	54.25	1378	211.00	5359	2.00	51	2.06	52	1.75	44	9.50	241	2.06	52	6.63	168	1" NPTF	1.6	21.4	510	
1904-2601-4260	167.75	4261	57.00	1448	224.75	5709	2.00	51	2.06	52	1.75	44	9.50	241	2.06	52	6.63	168	1" NPTF	1.7	22.9	535	
1905-2601-5790	227.88	5788	60.75	1543	288.63	7331	2.00	51	2.06	52	1.75	44	9.50	241	2.06	52	6.63	168	1" NPTF	2.1	27.7	601	
1905-2601-6731	265.00	6731	70.88	1800	335.88	8531	2.00	51	2.06	52	1.75	44	9.50	241	2.06	52	6.63	168	1" NPTF	2.5	32.3	674	
2155-2601-5588	220.00	5588	60.13	1527	280.13	7115	2.00	51	2.06	52	1.75	44	10.63	270	2.06	52	6.56	167	1" NPTF	2.2	34.7	697	

Please consult factory or your Regional Sales Manager for additional models.